

3D Miniatures Christmas Tree

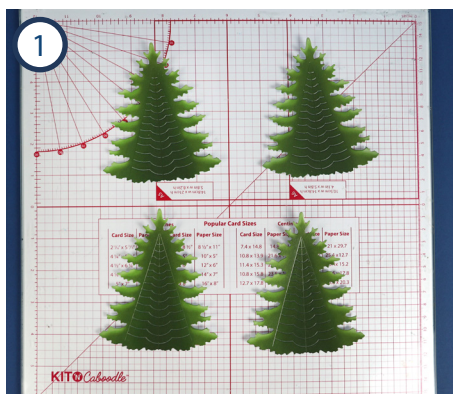

1 Cut four of the Christmas Tree.

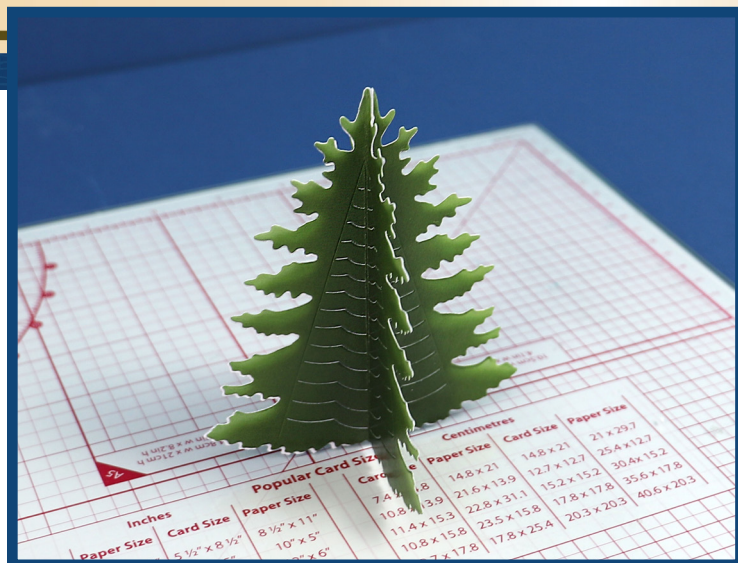
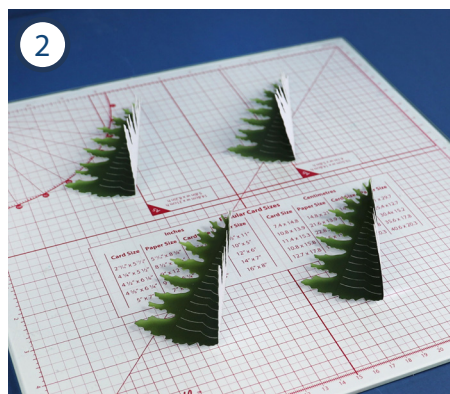

2 Score and valley fold each die cut into right angles as shown.

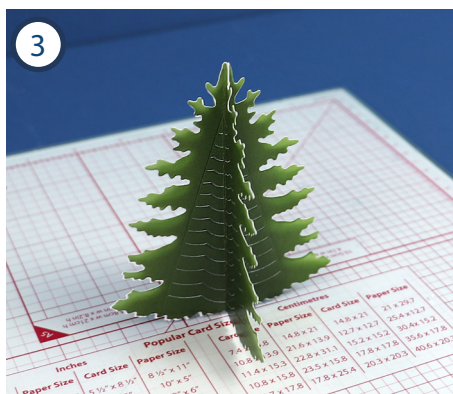

3 Stick the trees together to create the Christmas Tree.

See overleaf for an
alternative way to use the
Christmas Tree die set

3D Miniatures Christmas Tree

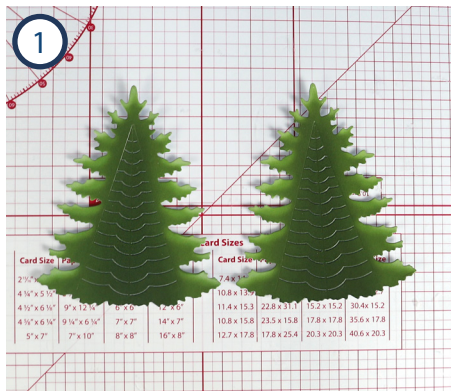
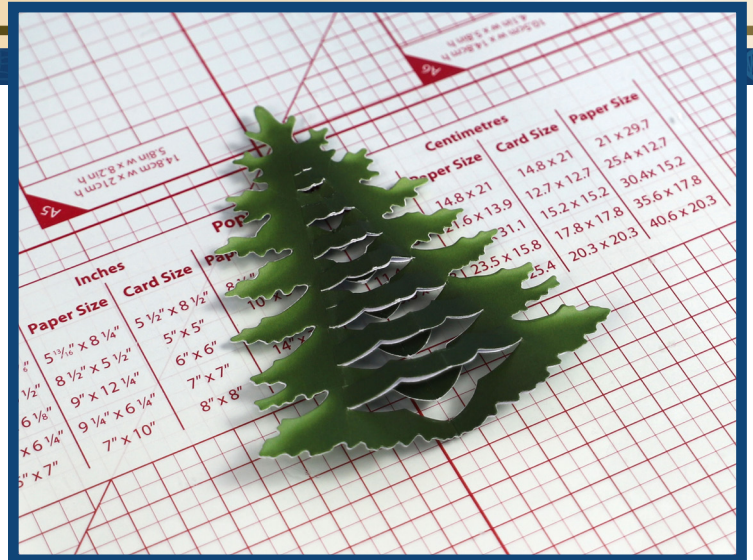

1 Cut two of the Christmas Tree.

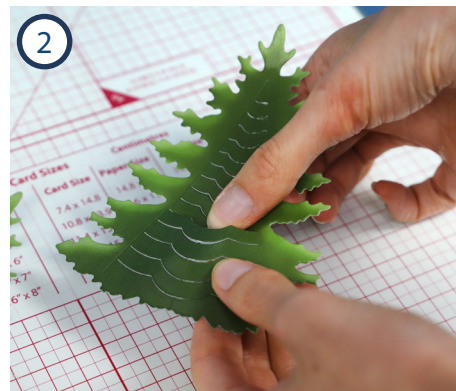

2 Bend the curved sections in alternating directions so that they protrude forwards and backwards in a pattern. Do the same for the remaining tree, but in the opposite pattern.



3 Stick the trees together.