

Concertina Card

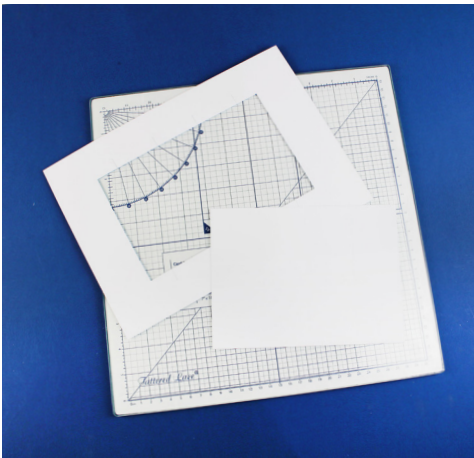

1. Using the Concertina card die set, cut one Large Concertina Card and one Large Concertina Insert from your chosen cardstock.

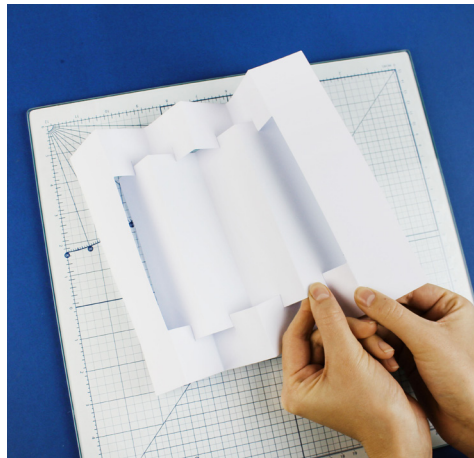

2. Using the Large Concertina card, fold along the score lines. From the left, mountain fold, then valley fold. Carry on until all score lines are folded. Repeat for the Large Concertina Insert. Slot the insert into the slits on the Large Concertina Card.

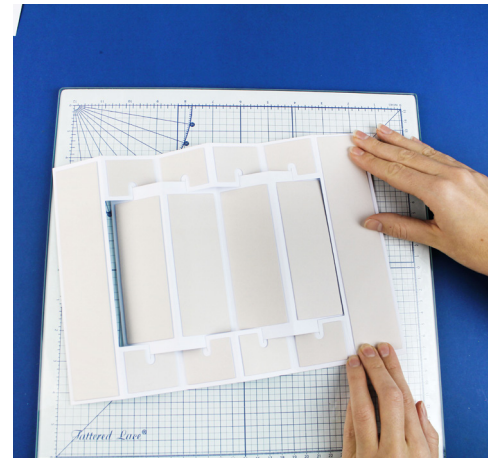

3. Using the Mats from the Concertina Card die set, cut from your chosen colour cardstock and mat onto the corresponding panel.



4. Decorate the insert with the panels from the corresponding die set. For example, Panel 2. Finish with paper flowers.

