

Vintage Venetian Card Shape

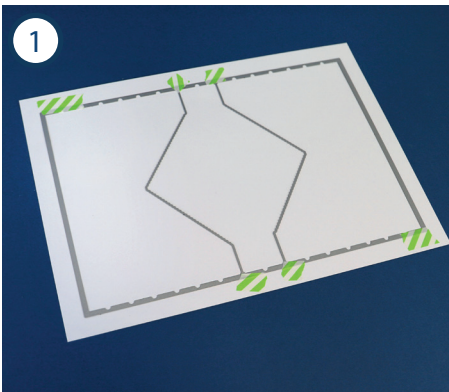

1
Secure the Notched Frame onto an A4 piece of white cardstock. Insert your chosen Half Shape dies into the frame using the Link System.

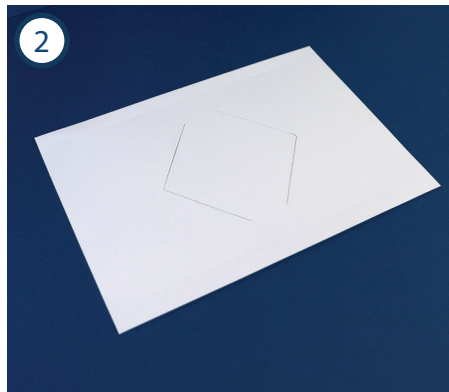

2
Run through the die cutting machine to cut a swing into the centre.

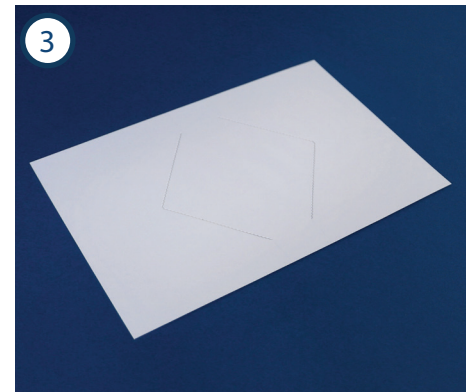

3
Trim the card down to your desired size if necessary. Rescore along the scored lines for easier folding if desired.

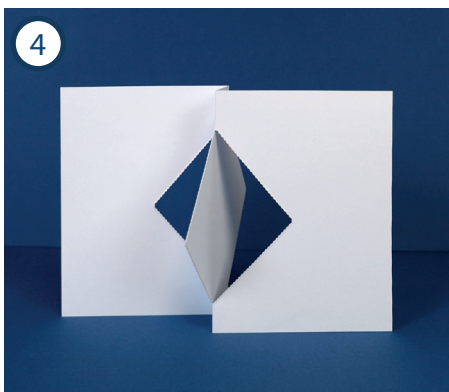

4
Valley and mountain fold to create the swing card as shown.

Vintage Venetian Card Shape

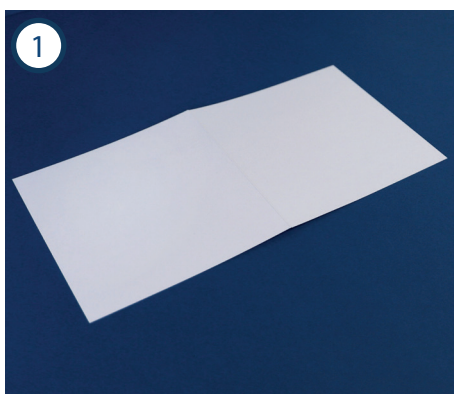

1 Place one of the score line dies into the centre of the Notched Frame. Cut into a piece of A4 cardstock to create the base card.

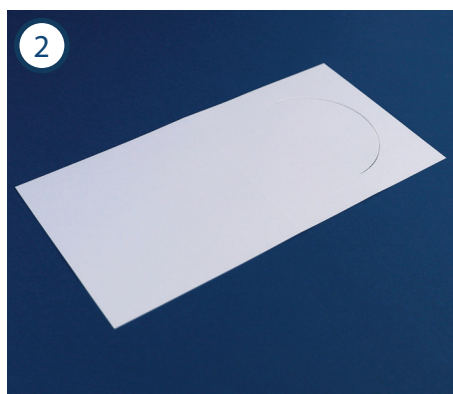

2 Slot a Half Shape die into one side of the frame using the Link System. Run through the die cutting machine to cut the half shape into the card.

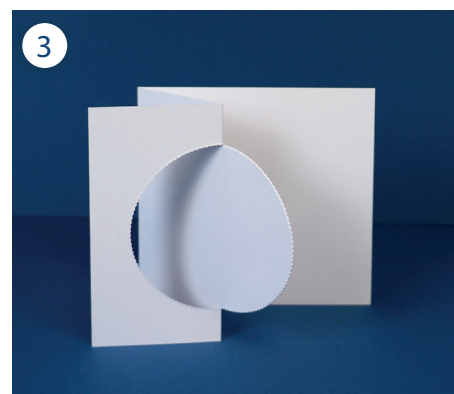

3 Fold back the card front to create the card as shown.

